

# User Guide

## Library open hours

9:30 ~ 17:00

## Reader Service

Reading room open hours 9:30 ~ 17:00

Call-slip acceptance 9:30 ~ 16:30

## Photoduplication services

Same-day photoduplication requests 10:00 ~ 16:00  
(Printouts of electronic resources on the same day)

Later date photoduplication requests 10:00 ~ 16:30  
(sent by mail)

Receiving copies at the Printout Counter 10:30 ~ 12:00  
13:00 ~ 16:30

## Closed

Mondays

National holidays (except Children's Day on May 5)

Year-end and New Year's Holidays

Third Wednesdays of the month (for refiling)

**Access** 10 minutes' walk from JR Ueno Station (Park Exit)

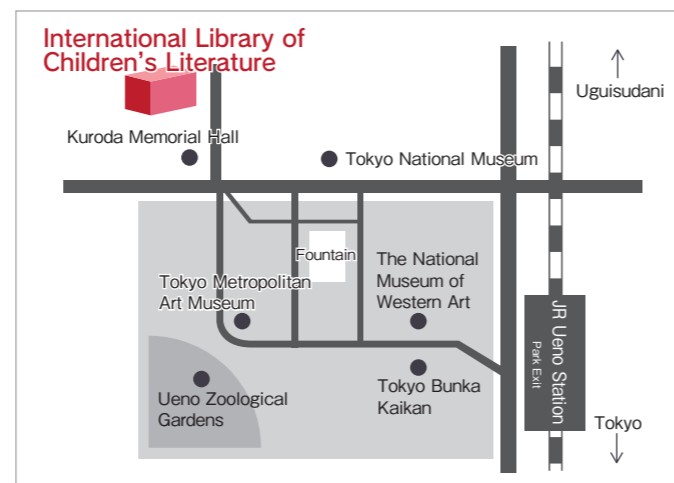

Arch Building

The ILCL is composed of the Brick Building, in which both children and adults can experience the joy of children's literature, and the Arch Building, which serves as a library specialized in children's books.

The Brick Building was constructed as the Imperial Library in 1906, and was reused as the Ueno Branch of the NDL for many years after World War II. It was partially opened to the public in May 2000 and was fully opened in May 2002. The Arch Building was newly completed to the northwest of the Brick Building in 2015. The building is shaped in a gentle arc.

## National Diet Library

# International Library of Children's Literature



Brick Building

## International Library of Children's Literature

The International Library of Children's Literature (ILCL) is a sole national library specializing in children's literature which provides internationally coordinated library services for children's literature and related materials published in Japan and in other countries. The ILCL was founded in January 2000 as a branch of the National Diet Library (NDL). Based on the philosophy "Children's books link the world and open up the future!", the ILCL plays a part of the NDL, and fulfills three basic roles: as a library dedicated to children's books, as a place where children encounter books, and as a museum of children's books.

 National Diet Library

## International Library of Children's Literature

12-49 Ueno Park, Taito-ku, Tokyo 110-0007, Japan

Tel +81-3-3827-2053

+81-3-3827-2069 (Automated voice information service)

Fax +81-3-3827-2043

Website

<http://www.kodomo.go.jp/>

Email Magazine (in Japanese)

<http://www.kodomo.go.jp/about/mailmagazine/index.html>

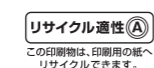



**The following actions are prohibited in the Library**

- ▲ Photography in prohibited areas
- ▲ Use of mobile phones for phone calls outside of designated areas
- ▲ Eating and drinking outside of designated areas
- ▲ Smoking

Please check notices inside the library for details.

- |  |   |  |                        |
|--|---|--|------------------------|
|  | Men's restroom  |  | Women's restroom       |
|  | Multipurpose restroom   |  | Ostomate               |
|  | Coin-operated lockers<br>※The coin is automatically returned when the lock is opened. |  | Money-changing machine |
|  | Cafeteria   |  | Water cooler           |
|  | Eating area   |  | Aid Station            |
|  | Diaper changing seat  |  | Nursing space          |
|  | Pram park   |  | Elevator               |

# 1F

## Arch Building

### Seminar Room 1 and Seminar Room 2

These rooms are used for children's literature related lectures, various seminars and events for children.

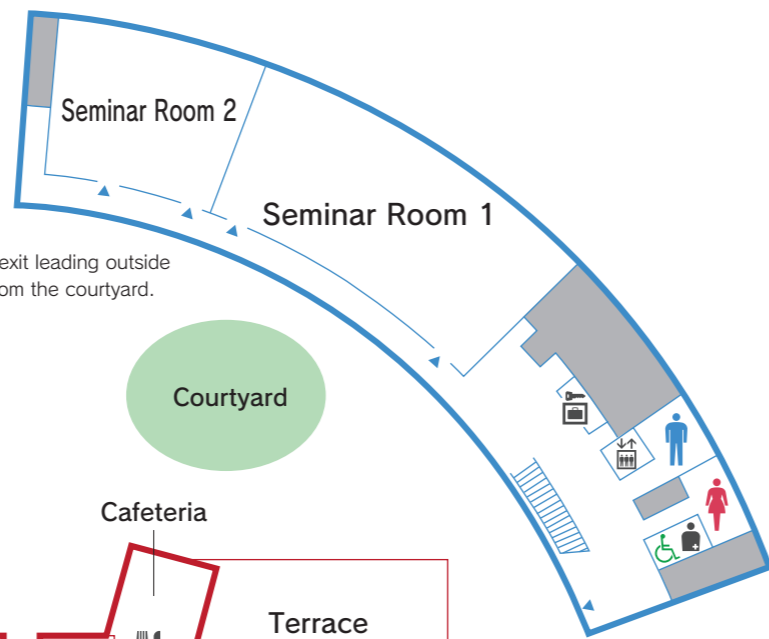

## Brick Building

### Children's Library

Classical picture books, stories or standard knowledge books mainly for children of up to elementary school age are available here.

### Meet the World

Materials on the geography, history and folklore of various countries and regions of the world are available here. These materials will stimulate children's interest in the world and enable a deepening of their understanding of other countries. Materials are also available in a variety of languages.

### Story Hour Room

Used for storytelling and reading events for children. In addition, nursery rhyme and picture book readings are also held for children between the ages of 6 months and 3 years and their parents or guardians.



# 3F

## Brick Building

### Hall

An exhibition which introduces the ILCL is available. Events such as concerts are also held here.

### Museum

Exhibitions which cover a variety of subjects on children's literature are held here.

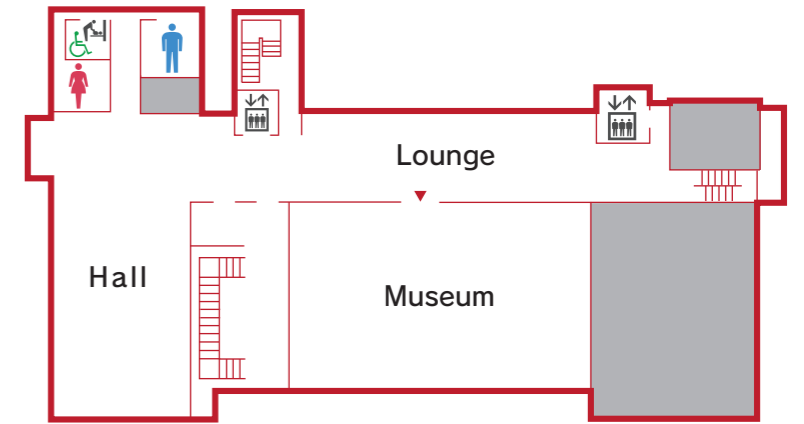

# 2F

## Arch Building

### Researchers' Reading Room

Useful materials for researching children's literature are available here. User registration is required to access this room and to use materials stored in the closed stacks. You can make a request for materials in the stacks from the user terminals located in the room.

A part of the children's literature collections and related materials, as well as textbooks currently used in schools in Japan, are available on open shelves. Also, DVDs, CD-ROMs and microfilm materials can be used. The room also features a corner which has materials related to the promotion of reading activities as well as a corner for small exhibitions on periodic themes.

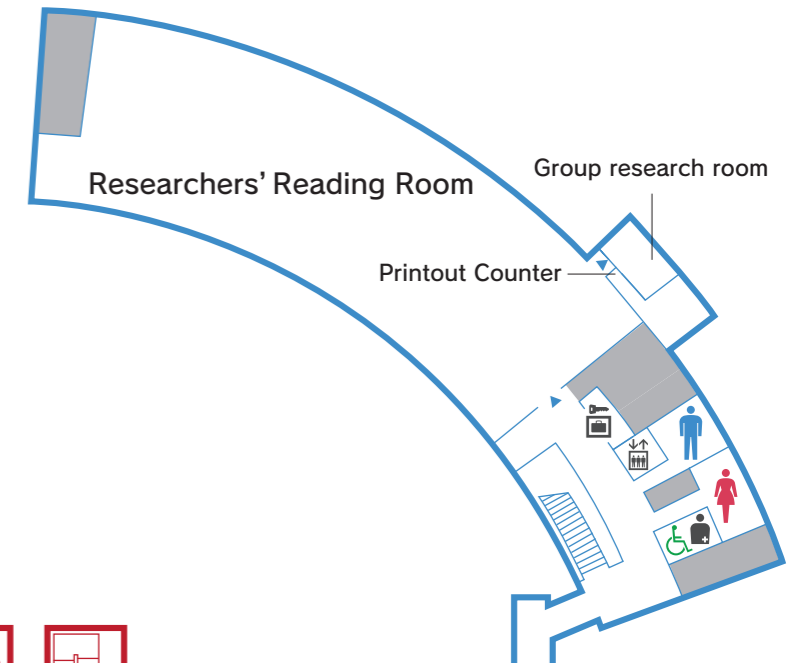

## Brick Building

### Teens' Research Room

Materials mainly useful for teens' research and assistance with research-oriented learning are available here. A research practice program is also provided (advanced reservation required).

### Gallery of Children's Literature

A gallery showing the history of Japanese children's books from the Meiji era to the present is available here.

